

# Motorized Shades Instructional Guide

Version 1

## How to Pair Shades with Shade Flow App

**A1** Download the **Shade Flow** app on your phone.



**A2** To start up and pair shade, you must first switch on your shade, located on the **top of head rail**.



**A3** Create a username, then select sync with existing account.

We have noticed that you are a new user. Do you want to get share from an available account or add a device by yourself?

Sync with existing account

Add by yourself

**A4** Icon will pop up "would like to use bluetooth" please select OK.

"Shade Flow" Would Like to Use Bluetooth

To build connecting between Shade Flow and shade · Bluetooth must be activated on your phone or tablet, Is Bluetooth allowed to be accessed?

Don't Allow

OK

**A5** Another icon will appear shown below. Please select OK.

"Shade Flow" Would Like to Access the Camera

(Camera permission needs to be turned on to scan the device and take photos) is camera access allowed?

Don't Allow

OK

**A6** Once you allow camera access, the below icon will appear shown "**Use Hotspot**" or "**Scan QR code**", select QR code and scan with your phone.

Use Hotspot

Scan QR code

**A7** "Sync with existing account" will appear once QR code is scanned. Select Confirm.

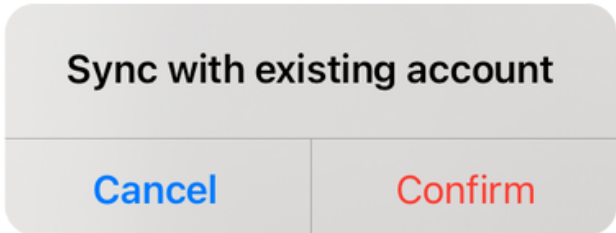

**A8** Choose a room icon then name the room and tap on **save** on the top right corner.

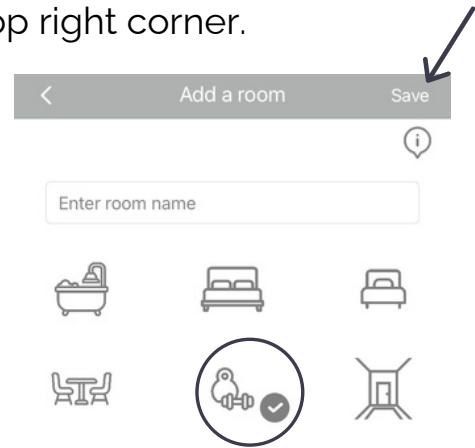

**A9** Next, **Rooms** page will appear. Tap on the **room icon you chose** to proceed.

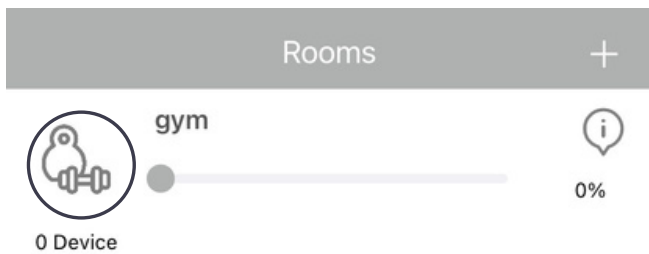

**A10** The room page you named will be displayed. To move forward, tap on the **+** icon



**A11** The Selection box titled, "Add a device" will pop up. **Select add existing device.**

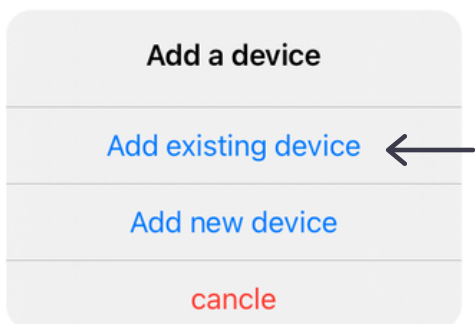

**A12** Next, "Add a device" page will appear. Tap on the shade until you see the **✓** selected in bold, then tap on **save** in the **top right corner.**

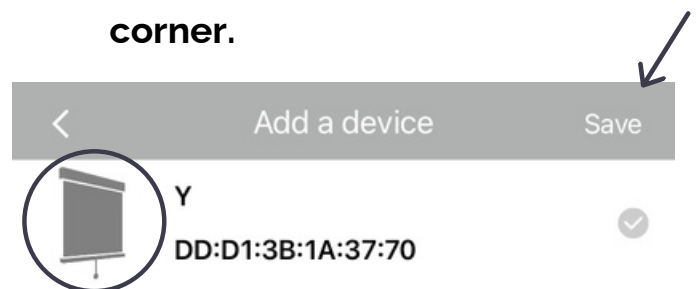

**A13** The **shade control page** will appear. **Select the shade**, so you can now control it by dragging the pill-shaped icon up and down.



## Pairing a Remote to Shade

**B1** On the shade control screen, click on the **shade icon**, select **setting** on the top right corner to pair your remote.

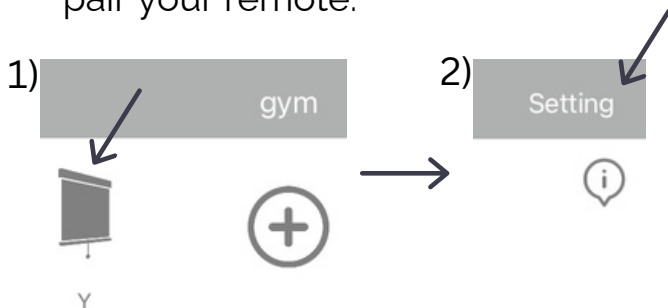

**B2** In the settings page, select **pair a remote**, then choose **“Pair by clicking C”**, the shade will jog to show it is in pairing mode.

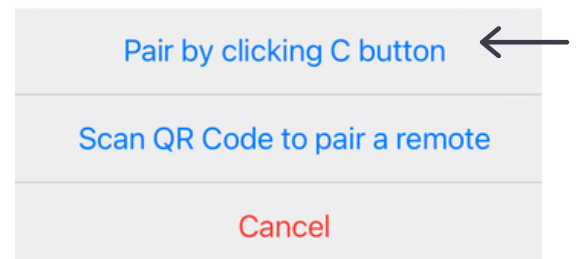

**B3** Lastly, use a **pen-like object** to **press the C button** located on the **back** of the remote, prompting the shade to jog and indicating successful pairing.

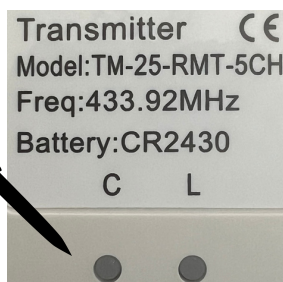

# How to Set Limits for Shade

**C1** Open the **shade control screen**, and on the top right select **settings** that will show your device settings. Then select **limit settings**.

**C2** "Limit Setting" icon will pop up, select **confirm**.

**C3** Click on the **Down button**   
Your shades will start to lower.

**C4** Press  when you think it is okay to stop, then click **Next**.

**C5** Click on the **Up button**   
Your shades will start to go up.

**C6** Press  where you think is your desired position. Then click **OK** to complete.